



Yes, you can.®

---

# User Manual

English



**rea™ Clematis®**

**rea**

**CE**



# Contents

Parts of the wheelchair	4
Product description	5
Intended use	5
General information	6
Caution and warning	7
Lifting the wheelchair	7
Product information	8
Upholstery	8
And frame colours	8
Accessories	8
Technical data	9
Assembly	10
Settings	13
Legrests	13
Footplates/calf pads	14
Armrests	14
Carer-operated angle adjustment	15
Height adjustable push handles	16
Height adjustment back	16
Anti-tip devices	17
Brake	17
Carer-operated brakes	18
Seat depth adjustment	18
Balance and stability	19
Seat heights	20
Accessories	21
Trunk supports	21
Trunk support swing away	22
Pelvic belt	23
Abduction cushion	24
Transporting wheelchairs with users in vehicles	25
Crash test protocol rea clematis	26
Restraint methods	27
How to disassemble your clematis to transport it as luggage	28
Safety instructions/propelling techniques	30
Guarantee	32
Maintenance	32
Recycling	33
Surface treatment	33

# Parts of the wheelchair

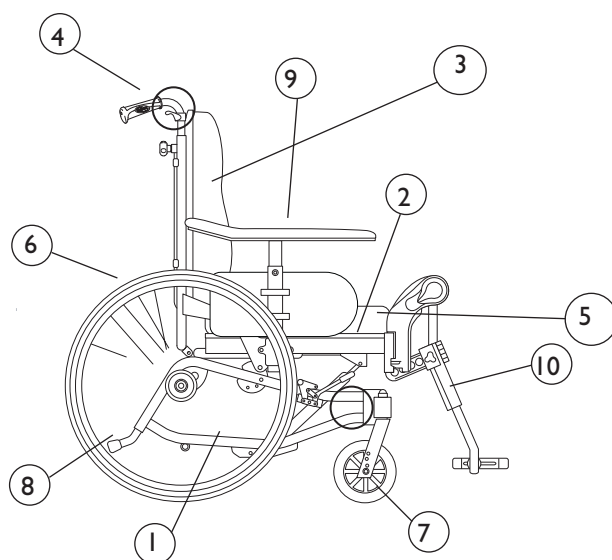

1. Frame, lower section
2. Seat frame
3. Backrest
4. Push handles
5. Seat
6. Rear wheel
7. Castors
8. Step tube/Anti-tip device
9. Armrests
10. Legrests

# Product description

## REA™ CLEMATIS®

The Rea™ Clematis®'s seat frame, push handles and certain other components subjected to strain are made of steel. Legrests are made of high quality aluminium.

Castor suspension and the jointed parts of the frame are made of polyamide reinforced with fibreglass. The backrest plate is also made of polyamide reinforced with fibreglass. Plastic details are marked for recycling. Seat and backrest cushions are made of foam rubber and the upholstery is made of washable plush or elastic polyurethane cloth.

The Rea™ Clematis® is a carer-operated wheelchair with an angle-adjustable seat unit. The angle of the backrest unit can be adjusted independently of the seat. The controls for the seat and backrest angle adjustment are included on the push handles. The Rea™ Clematis® is available in three seat widths. The armrest height of each chair can be adjusted.

The wheels can be pneumatic or semi solid.

The seat and backrest pads have been ergonomically designed for the user. They are to provide as much stability and comfort as possible, as well as good pressure distribution.

## Intended use

The Rea™ Clematis® is a manual wheelchair, intended for users who have a low level of activity and who sit in the wheelchair for long periods. The comprehensive comfort and stability provided by the backrest and the option of seat unit and backrest angle adjustment provide the user with relaxed and comfortable rest.

- Regarding both operation and manual adjustment of the seat unit the Rea™ Clematis® is intended for operation by the carer.
- The Rea™ Clematis® must be used with its seat and backrest pads.
- The max. user weight is 125 kg.
- The service life of the chair depends on its application, the user's degree of activity as well as care and maintenance.

# General information

Rea™ Clematis® is a wheelchair with many adjustment options and accessories. To ensure that you benefit as much as possible from Rea™ Clematis®, and in order to do it's options justice, the chair must be tested and adjusted by competent personnel. We hope that you have also received instructions for using your Rea™ Clematis® in everyday life.

This manual includes a description of the parts of the chair, simple adjustment options, how to use the Rea Clematis® safely and how to transport it. The manual must be read thoroughly before the chair is used.

Also included in this manual is a description of how the accessories are fitted and slightly more advanced settings.

As the Rea™ Clematis® has many different components and accessories, the appearance of the accessories you have for your chair may differ from those shown.



## **NB!**

Invacare® is only responsible for product changes carried out by personnel who we authorise. We reserve the right to make any changes to equipment and specifications without prior notice.

## **Delivery check**

Check that all components match the delivery note. Any transport damage must be reported immediately to the transport company. Remember to keep the packaging until the transport company has checked the goods and a settlement has been reached.

## **Daily performance check**

Check that the following parts are securely fitted and operational on the wheelchair:

- Wheels
- Backrest
- Anti-tip device
- Push handles
- Footrests

## CAUTION AND WARNING

Failure to comply with instructions given may result in personal injury and/or product damage.

- Check the following points before the wheelchair is used:
  - all parts are securely fastened to the frame.
  - all handles and knobs are properly tightened.
  - that all brakes and anti-tip devices function correctly
- Never lift the chair by the removable armrests, or by the footrests. Ensure that the backrest and push bar are securely fastened to the chair.
- Remember that with every alteration to the chair's balance the inclination to tip, forwards or backwards, also changes.
- When fitting accessories etc. always take care not to trap your fingers.
- There is always an increased risk of trapping parts of your body when tilting the wheelchair's back and seat.
- The width of the seat should never be adjusted so much so that the inside of the armrests press against the side of the pelvis.
- Apply the brake whenever the occupant is to be moved into or out of the chair.

- Never stand on the footplates when getting in or out of the chair, because of the risk of tipping over.
- We recommend that the chair should be fitted with castor adapters when the seat is located in its most forward position.
- The handrims may become hot due to friction, and this may cause injury to your hands.
- Remember that the effectiveness of the carer-operated brake is reduced in wet and slippery conditions, as well as when on a slope.
- Be careful to ensure that the drive wheels are securely attached.
- Drive wheels are not to be detached while the user is sitting in the chair.
- Surfaces of the wheelchair like frame parts or upholstery can reach temperature > 41 degrees C if they have been exposed to the sun during a longer period of time. .



This symbol means warning and is used throughout the manual for information that needs special attention

## LIFTING THE WHEELCHAIR

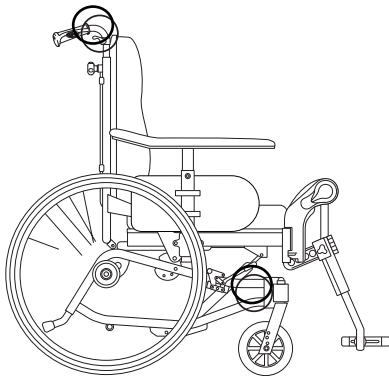

Always lift the wheelchair by gripping the frame at the points shown in the diagram. Never lift the wheelchair by the removable armrests or the foot-rests. Ensure that the backrest and push handles are securely in place. Also read the chapter: Safety instructions/propelling techniques.

# Product information

<b>Seat width</b>	39, 44, 49 cm
<b>Seat depth</b>	42-48 cm
<b>Backrest height</b>	55 cm

## UPHOLSTERY AND FRAME COLOURS

<b>Upholstery</b>	Grey Dartex TR23
<b>Frame colours</b>	Pearl grey

## ACCESSORIES

Rea™ Clematis® has a wide range of accessories and options. Some of the accessories may not be available in all countries.

<b>Castors</b>	200 mm and 150 mm solid
<b>Rear wheels</b>	12", 22", 24"
<b>Other</b>	Trunk supports Pelvic belt Abduction Cushion Arm rest spacer Clamp for intravenous drip Table Tray Locking device for table tray

# Technical data – Rea™ Clematis®

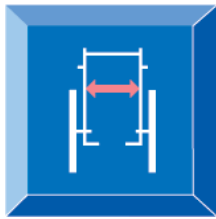

39, 44, 49 cm  
+ 2 cm with the  
spacers



42-48 cm



40-45 cm\*1

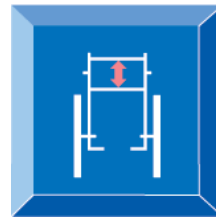

60-71 cm \*1,2

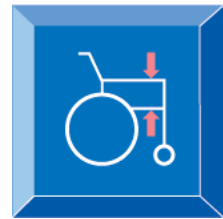

23-34 cm \*1



40-52 cm



-1° – +19°

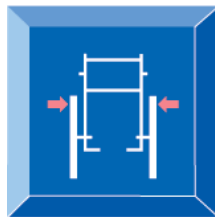

Seat width + 21 cm

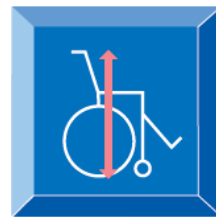

96-112 cm\*2



112-148 cm



-1° – +32°



Max 125 kg



Transport weight  
20,5/21/21,5kg.\*3

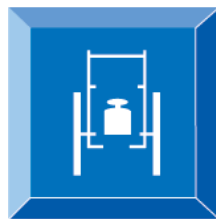

30, 32, 33,5 kg



Transportation  
dimensions \*4

- \* 1 : Measured from seat plate
- \* 2 : Excluding neckrest and push handles
- \*3: Without rear wheels, neckrest, armrests,  
legrests, trunk support and seat cushion
- \* 4: Width 39 (h 59,5 x L 84 x 58,5 cm)  
Width 44 (h 59,5 x L 84 x 63,5 cm)  
Width 49 (h 59,5 x L 84 x 68,5 cm)

# Assembly

1a.

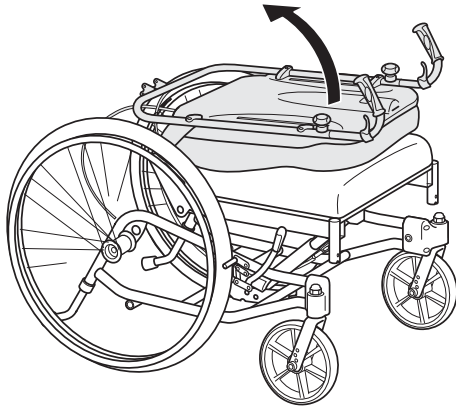

When you receive your wheelchair, you must fit the backrest into place and fit the neckrest, armrests and legrests onto the chair. The assembly is simple and does not require any tools.

## 1a. Fitting and securing the backrest

Unfold the backrest into an upright position.

1b.

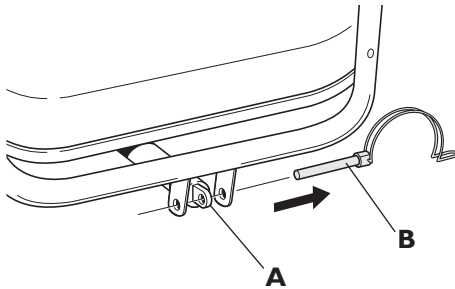

1b. Secure the piston (A) using the pin (B).

1c.

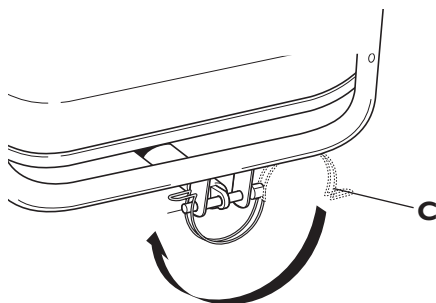

1c. Lock the pin using the lock shackle/loop (C).



Check that the shackle/loop is securely locked.

2.

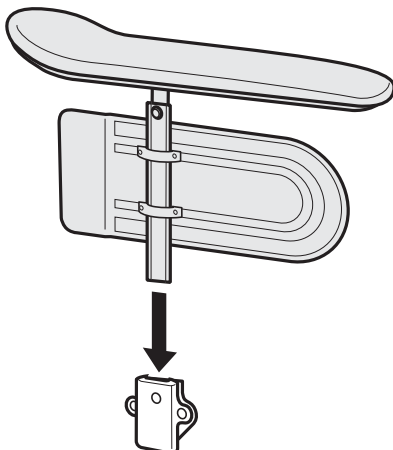

## 2. Armrests

The armrests are fitted onto the wheelchair by pushing them down into their attachments on the edge of the chair seat.

3a.

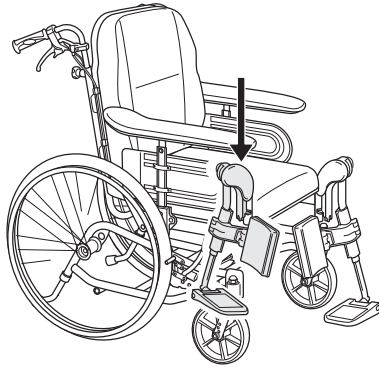

3b.

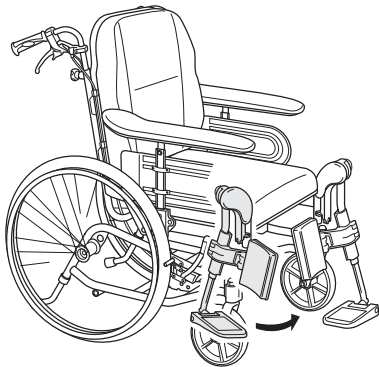

### 3a. Legrests

Attach the legrests by pushing the tube at the upper part of the legrests down into the tubes on the wheelchair. You must angle the legrests outwards when inserting them.

3b.

Lock the legrests by turning them inwards. The legrests are automatically locked so there is no risk of them coming off the wheelchair.



Be careful not to trap your fingers between frame and legrest.

4.

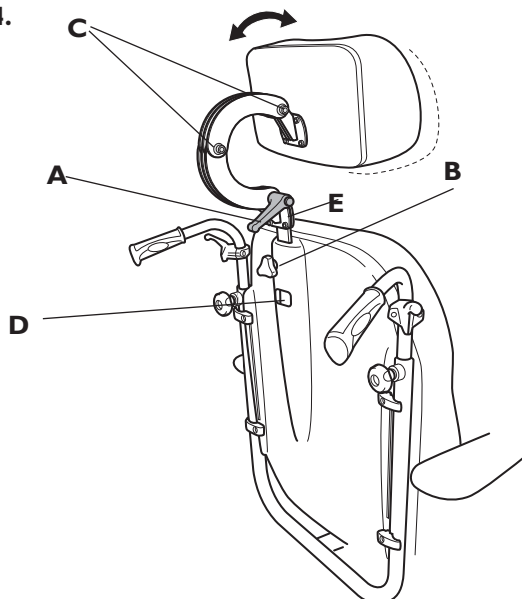

### 4. Neckrest

You attach the neckrest by putting it into the receiver on the backrest and fasten it with the knob (B).

Adjust the position with the lever (A) and nuts (C). Adjust the height by loosening the knob (B). Part (E) is a memory function for the height of the neckrest. When the desired height is achieved, loosen the screw on the memory and lower it towards the back. Fasten the screw again.



Pay attention to how far the neckrest is raised. If the red marking (D) is visible, the neckrest is raised too high.

5.

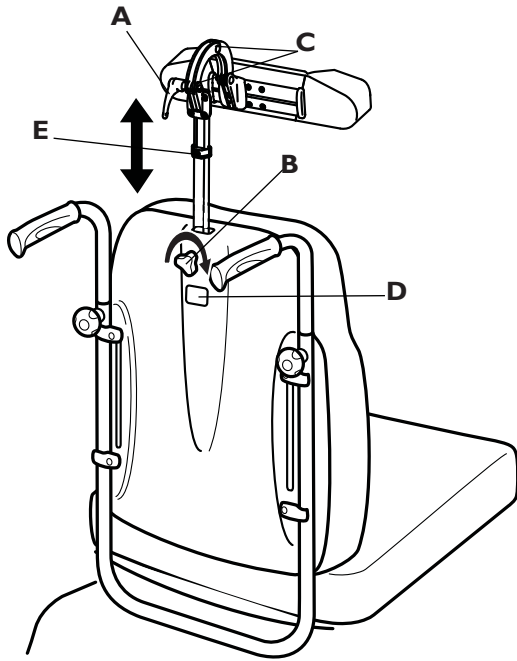

### 5. Headrest

You attach the neckrest by putting it into the receiver on the backrest and fasten it with the knob (B).

Adjust the position with the lever (A) and nuts (C). Adjust the height by loosening the knob (B). Part (E) is a memory function for the height of the neckrest. When the desired height is achieved, loosen the screw on the memory and lower it towards the back. Fasten the screw again.



Pay attention to how far the headrest is raised. If the red marking (D) is visible, the headrest is raised too high.

# Settings

## LEGRESTS

1.

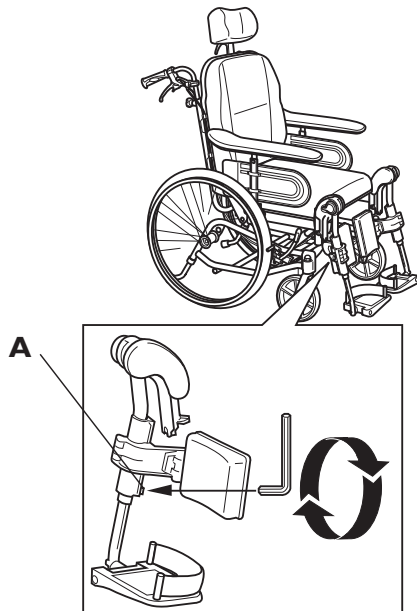

Tools: 5 mm Allen key.

2.

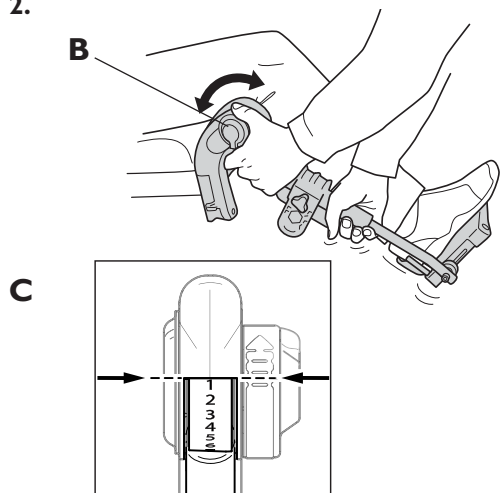

Angle adjustable legrests support the legs and reduce pressure. The legrests can be used for bandaged legs, but not for legs in plaster casts. The legrests must always be fitted with calf pads, footplates and heel straps.

It is important to adjust the height and angle of the legrests to obtain a good seating position.

### 1. Height adjustment

Loosen screw (A) with an Allen key. Adjust the legrest into a suitable height and the screw is caught by one of the recesses on the legrest tube. Then retighten the screw.

### 2. Angle adjustment

Pull the lever (B) with one hand while supporting the legrest with your other hand. When a suitable angle is obtained, let go of the lever and the legrest will lock into one of seven preset positions (C).



Do not place anything heavy, or let children sit on the legrest. It may cause damage to the mechanism.



The distance between the lowest part of the footrest and the ground must be at least 40 mm.

## FOOTPLATES/CALF PADS

1.

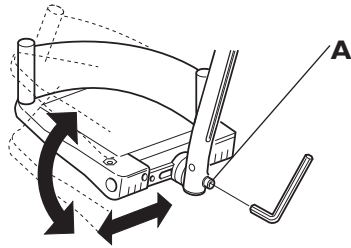

Tools: 5 mm Allen Key

2.

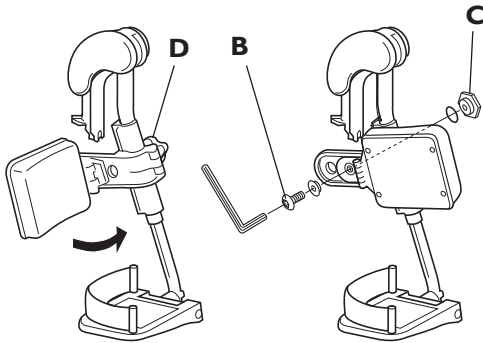

Tools: 5 mm Allen key.

### 1. Angle-adjustable footplates

Adjust the angle and the depth by loosening the screw (A) at the footplate attachment with a 5 mm Allen key. Adjust the footplate to the correct position and retighten the screw.



Do not place anything on the footplate when the screw is loose.

### 2. Calf pads

The calf pads can be fitted in four different depth positions. Swing the pad forwards. Unscrew screw (B) using an Allen key. Remove the large nut (C) on the reverse side and place it in the other attachment hole. Move the calf pad to the new position and secure it into place with the screw.

The height of the calf pads can easily be adjusted using the handwheel (D).

## ARMRESTS

1.

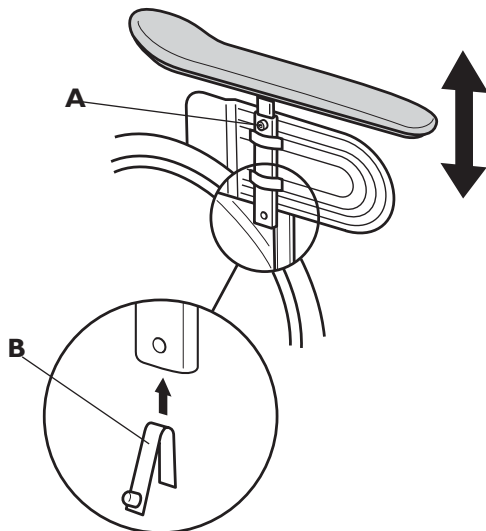

Tools: 5 mm Allen Key

The armrest has an auto-lock. Press the spring (B) before removing the armrest.

### 1. Armrest height

The height of the armrest can be adjusted by loosening the screw (A) with an Allen key. Adjust to the desired height and retighten screw. If armrest is adjusted too low it will conflict with the rearwheel when tilting the seat unit.



When adjusting the height, do not put your fingers between armrest pad and side plate as they may get trapped.

# Seat unit

## CARER-OPERATED ANGLE ADJUSTMENT

The wheelchair is equipped with carer-operated controls. You can adjust the angle of the backrest forwards or backwards and tilt the whole seat unit including the backrest. These two functions can either be controlled manually or electrically.

1.

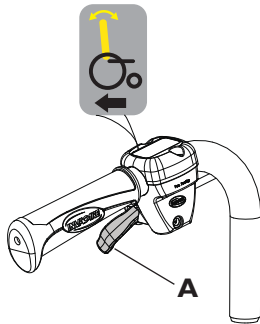

### 1. Backrest angle adjustment

Adjust the angle of the backrest by pulling the yellow **left-hand** lever (A) upwards and keeping it there whilst you push the backrest away from you or pull it towards you until you have obtained the required position. Release the lever (A).

2.

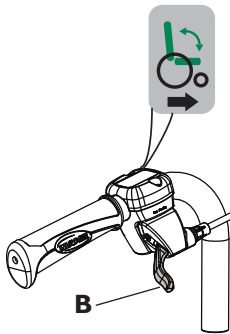

### 2. Tilt adjustment

Tilt of the seat unit (seat and backrest) by pulling the green **right-hand** lever (B) upwards and keeping it there whilst you tilt the seat unit to the required position. Release the lever (B).

3.

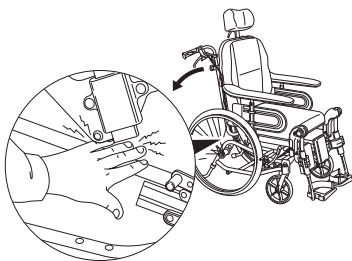

Be careful that you do not trap your finger between the seat and the armrest attachment (picture 3).

4.

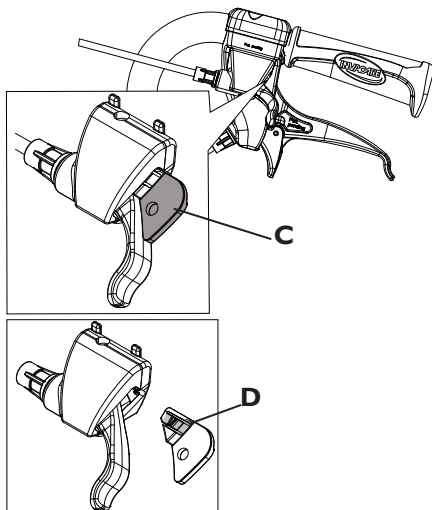

### 2. Tilt lock

The tilt lock (C) allows you to set the tilting of the seat unit and/or the angling of the backrest to a fixed position. Tilt and/or angle the seat and backrest to the desired position and insert the tilt lock. The position is now set and cannot be changed.

The tilt lock is removed by pressing the plastic peg (D) with a small object while pulling out the tilt lock.

## HEIGHT ADJUSTABLE PUSH HANDLES

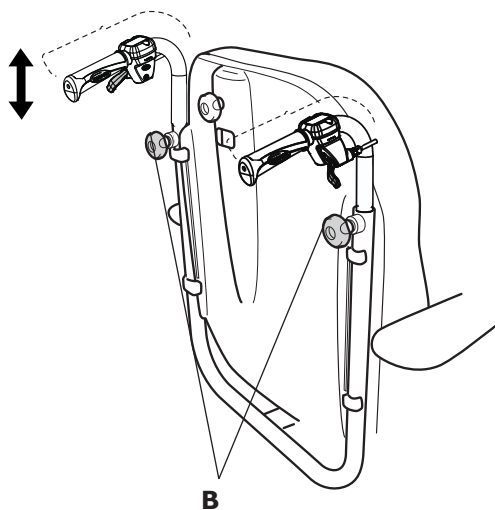

Adjust the height of the push handles (90 mm) by loosening the handle wheels (B). Adjust the push handles to one of the four positions, then retighten the handle wheels (B).

After adjusting the push handles, always make sure that the handle wheels are properly retighten.

## HEIGHT ADJUSTMENT BACK

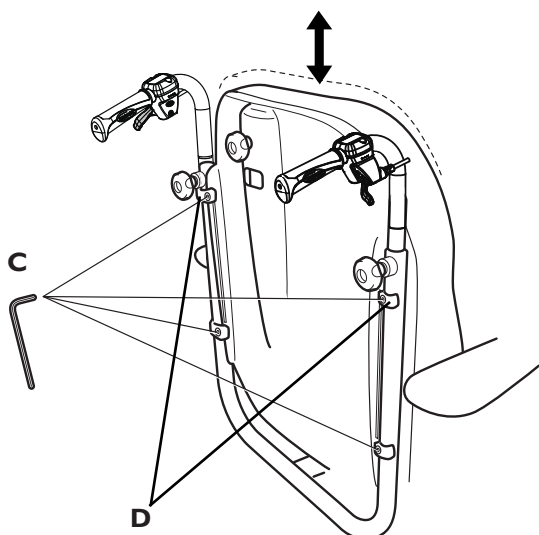

The height of the back can be adjusted variably. Loosen the four screws (C) and adjust the back to the desired height. Brackets (D) should be placed as high up as possible. Re-tighten the screws firmly.

Tools: 5 mm Allen key.

## ANTI-TIP DEVICES

1.

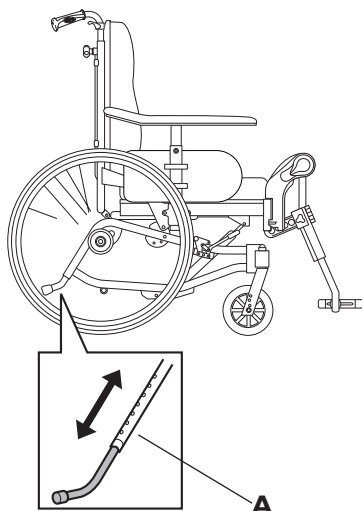

The anti-tip devices also act as step tubes. They are height-adjustable and can easily be set in six different positions.

Adjust the anti-tip devices by pressing the spring-loaded buttons (A) and then raising or lowering the anti-tip devices until you obtain the required position.



Ensure that both anti-tip devices are adjusted to the same position and that the spring-loaded buttons pop back into place in their new position.

## BRAKE

1.

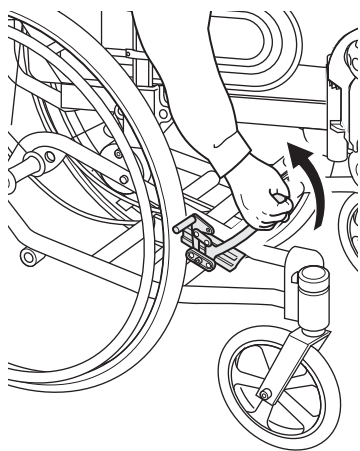

1. This type of brake is to be used when the wheelchair is stationary and is not intended to be used for reducing the speed.

To apply the brake of the wheelchair, move the lever backwards. To release the brake, move the lever forwards.



Take care not to trap your fingers between the brake pin and tyre.

2.

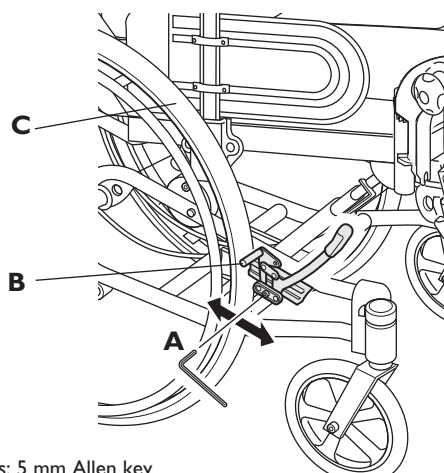

2. To obtain the correct braking effect, the brake pin (B) is to press into the tyre when you apply the brake. The brake may therefore need to be adjusted. Loosen the screw (A) and move the brake to the required position. Retighten the screw. There is to be a distance of 15 mm between pin (B) and tyre (C).



Incorrect setting or incorrect use of the brake reduces the brake effect.

Tools: 5 mm Allen key

## CARER-OPERATED BRAKES

1.

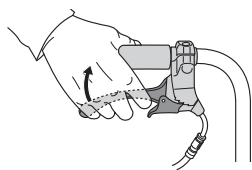

2.

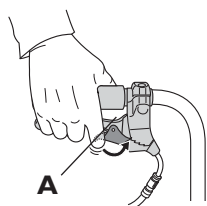

3.

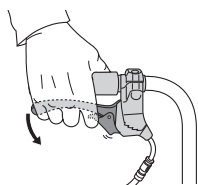

1. Brake when the wheelchair is moving: squeeze both brake handles upwards and the brake will be applied.

2. Lock the brakes: squeeze the handle upwards and move the lock catch (A) upwards. Then release the handle.

3. Release the brakes: squeeze the handle upwards and the lock catch will release automatically.

 Incorrect setting or use of the brakes will reduce the braking effect.

## SEAT DEPTH ADJUSTMENT

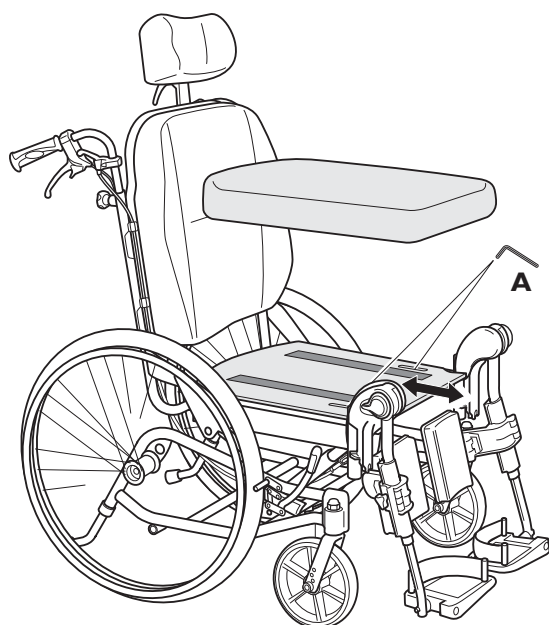

Tools: 5 mm Allen key

Adjust the seat depth by loosening the two screws (A). Push or pull the seat backwards (30 mm) or forwards (30 mm) to reach the wanted position. Retighten the screws.

## BALANCE AND STABILITY

Each setting can be adjusted in two ways:  
 II = easy to manoeuvre, less stable  
 III = stable chair, less manoeuvrability

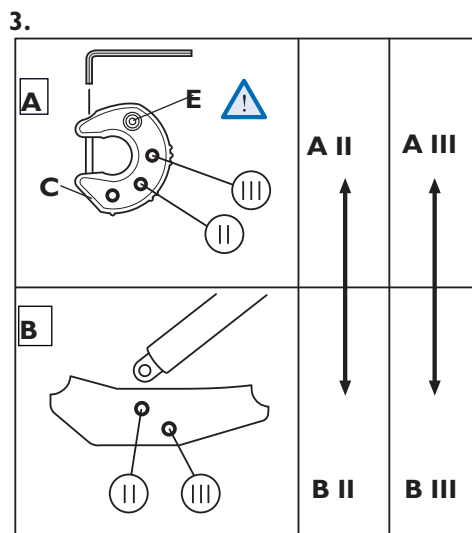
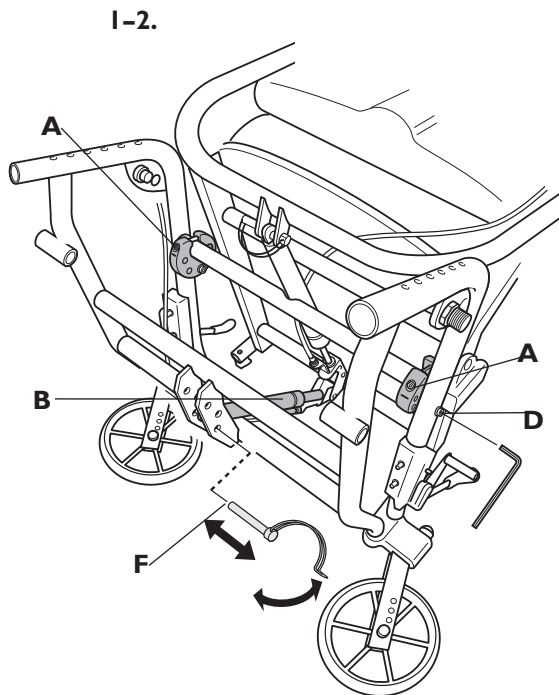

Check the stability with the user in the chair when the chair has been adjusted. Adjust the angle of the seat and backrest backwards to their maximum setting. Check the risk of tipping. Re-adjust the balance of the chair and/or anti-tip devices to obtain a chair that is stable in all situations.

By moving the seating section (seat plus backrest) either backwards or forwards, in relation to the lower frame (and also in relation to the rear wheel and castors) you also alter the chairs manoeuvrability and stability.

If the seating section is located in the forward position (III) the chair is more stable (in regard to tipping backwards), though slightly less manoeuvrable. However, the chair also becomes somewhat more susceptible to tipping forwards. If the seating section is located in the rear position (II) the chair becomes more manoeuvrable, though somewhat less stable (in regard to tipping backwards). This can be countered by lowering the anti-tip device, with which the chair is fitted. Subsequently, you have a wheelchair that is both manoeuvrable and safe.

If you want to alter the balance of the wheelchair it is necessary to adjust the two fittings (A) and position of gas piston (B) on frame bracket.. The two fittings are used to move the chairs seating section forwards and backwards and the gas piston enable you to move the fitting for the chairs angle adjustment mechanism.

It is important that the two fittings and the gas piston are adjusted and secured in the same relative positions (table 3).

### 1. Adjust the upper attachment.

Take away the seat cushion, seat plate, legrests and wheels. Put the chair with it's front facing down. Adjust each of the fittings in this way: Slacken the screw (C) on the upper side of the fitting by a couple of turns, but do not unscrew it completely. Unscrew screw (D) and turn the fitting until the correct position ( II or III) is aligned with the screw hole in the frame and then re-tighten screw (D). Then, re-tighten screw (C).

**NB – Never touch screw (E)!**



### 2. Adjust the lower attachment.

Pull out pin (F) on the gas piston by opening clamp and put the gas piston in position. For the right position, see table (3).

NB – Be sure the pin is secured again with clamp.

NB – There is a greater risk of tipping forward when the seat is extended to the front.

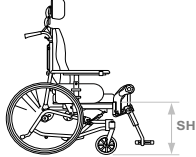
## SEAT HEIGHTS

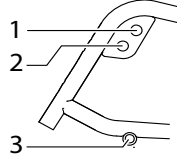
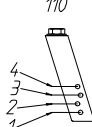
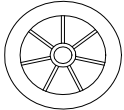
				
45	24"	2	1	200
40	22"	1	3	150
45	12"	3	1	200

# Accessories

## TRUNK SUPPORTS

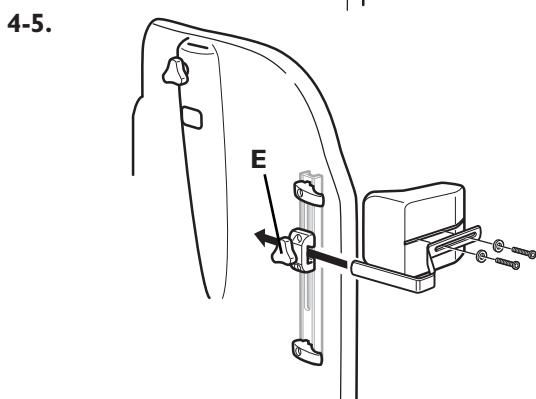
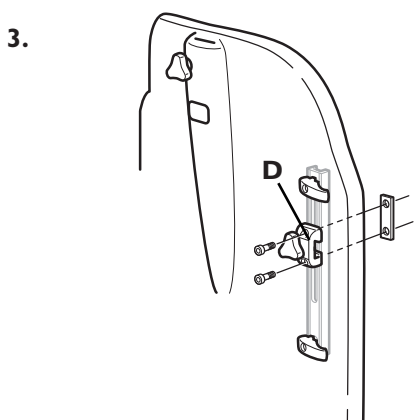
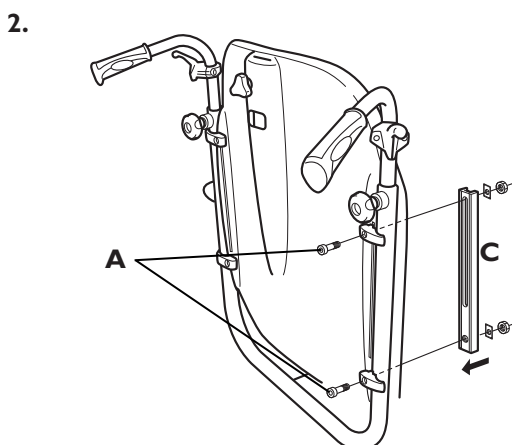
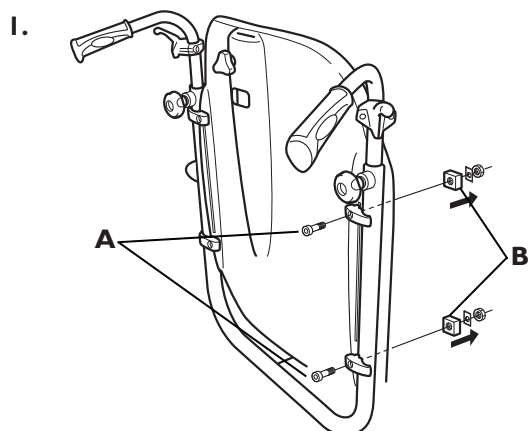

1. To install the trunk support unscrew screws (A) and remove the locking devices (B), washers and nuts.

2. Fasten bar (C) with screws (A), washers and nuts.

3. Fasten holder (D) with screws in the desired height.

4. Insert the arm of the trunk support in holder (D) and fasten with wheel (E).

5. To adjust the depth of the trunk support, unzip the cover to reveal the screws. Unscrew and move the trunk support forwards or backwards. Retighten the screws and zip up the cover.

Tools: Screwdriver

## TRUNK SUPPORT SWING AWAY

1.

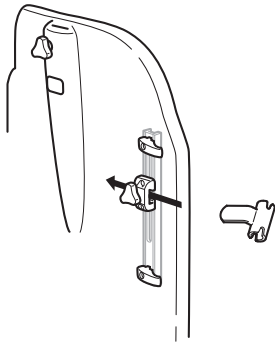

1. The attachment for the swing away trunk support is inserted into the holder on the back and fastened with the wheel. For instructions on how to mount the holder see page 20.

2.

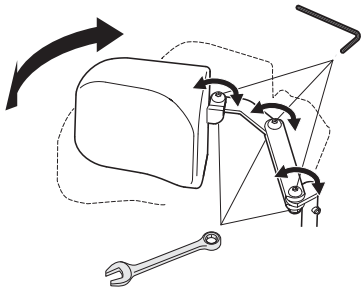

2. By loosening the nuts and bolts on the arm of the trunk support, the angle can be adjusted. Remember to secure tightly when the desired position is achieved.

Tools: 5 mm Allen Key  
13 mm fixed spanner

3.

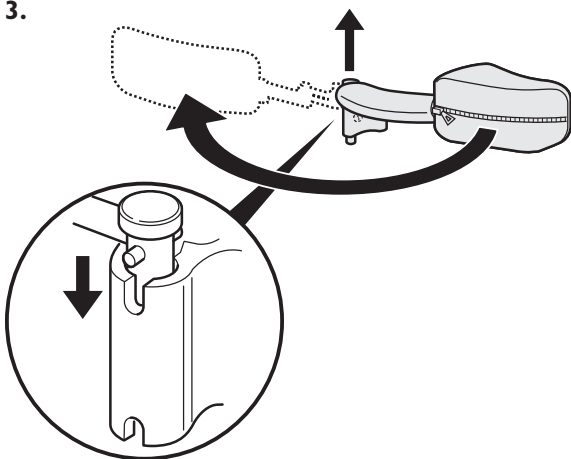

3. The trunk supports can be folded away so that they do not obstruct the user when he or she gets into or out of the chair.

## PELVIC BELT

1.

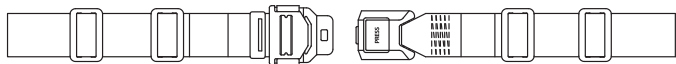

2-3.

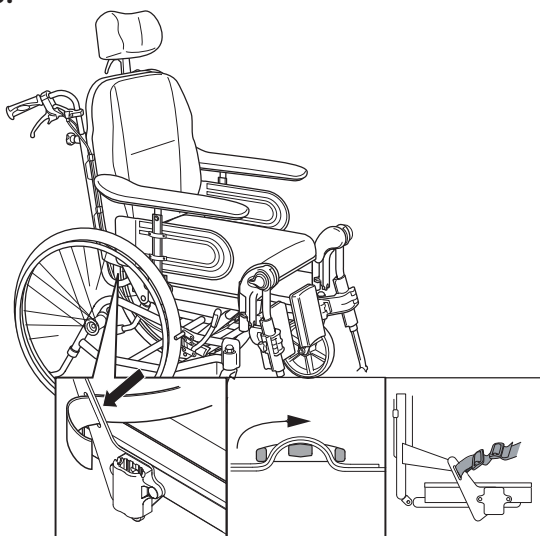

1. The pelvic belt is used to prevent the risk of falling or sliding out of the chair and for providing the user with a good posture.

2. The pelvic belt is mounted on the backrest brackets. Thread the belt through the mounting on the chair and then through the two plastic buckles as shown in the picture. It is important that both buckles are used. There is a danger the belt might slip if the belt is treaded through only one.

### 3. Adjustment

Ensure that the user is sitting fully back in the seat and that the pelvis is as upright and symmetrical as possible - not forward on one side or tilted back. Position the lap belt so that the hip bones can be felt above the belt. Adjust the length using the buckles so that there is just sufficient room for your hand to slide between your body and the belt. It is recommended that the clasp is kept in a central position, i.e. make adjustments to each side. These adjustments should be checked and possibly changed each time the belt is used.

4.

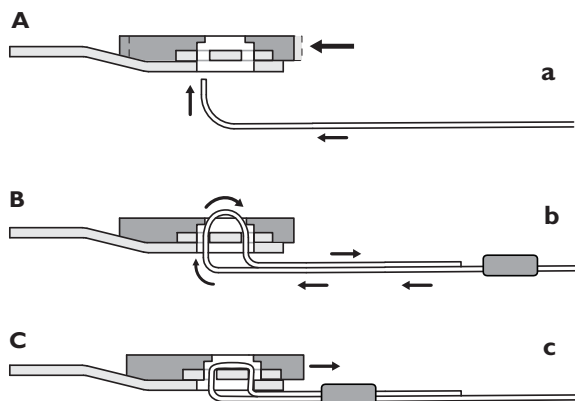

4. If the belt has come loose at the metallic buckle it should be threaded according to the pictures a-c. Please make sure that the belt cannot slide.

## ABDUCTION CUSHION

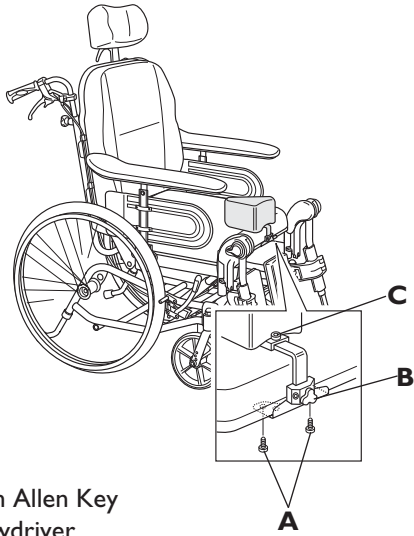

Tools: 5 mm Allen Key  
Screwdriver

The abduction cushion consists of an attachment that is fitted into the seat frame of the chair and a pad.

The height and depth of the abduction cushion can be adjusted. Place the attachment at the centre of the front of the frame. Secure the attachment by tightening screw (A).

Place the pad into the attachment and adjust the height using knob (B) and the depth using screw (C).



## TRANSPORTING WHEELCHAIRS WITH USERS IN VEHICLES

Invacare has continuously worked to improve the safety in all our products for the users in different everyday situations. This has, among other things, meant that Invacare since the mid 1990's has let accredited research institutes crash test several of the manual wheelchair models. We would like to inform you about the transport of wheelchairs with seated users in vehicles that are especially adapted for this purpose. First and foremost, we would like to point out that it is always the safest option for the user to be transported in the vehicle's regular seat fastened with the regular safety belt. Invacare cannot recommend transport seated in the wheelchair. But, we are aware that there are users and situations that require vehicle transport seated in the wheelchair. In these cases, the safety rules in this brochure must be followed in order to reduce the risk of injury in the case of an accident.

The wheelchair has been tested according to the specifications in ISO 7176-19 "Wheeled mobility devices for use as seats in motor vehicles". This means that it has been through and met the requirements in a standard test of one possible situation – full frontal collision in 48 km/h with a deceleration of 20 g and a 75 kg test dummy. The test standard ISO 7176-19 is developed by authorities and specialists and it states a minimum demand on wheelchairs regarding transport in vehicles. This standard is updated regularly as knowledge and experience increases.

In reality, an incident will be different from the circumstances in a test laboratory environment. For example will speed, impact angle, configuration of the chair, user weight and deceleration probably vary. Invacare declines any responsibility for the outcome of a possible accident where our products are involved. We have chosen to test what we believe to be a frequently occurring configuration with common adjustments made. Configurations and accessories that are unsuitable for seated transport in a vehicle are mentioned later on in this chapter.

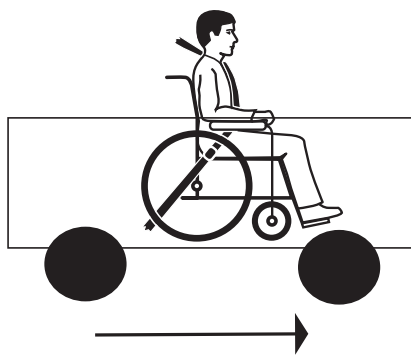

1. The wheelchair and user should be transported forward-facing in the direction of travel. All auxiliary equipment such as tables, trunk support, abduction cushion etc should be removed and stored safely so that they do not injure anyone during any kind of accident.

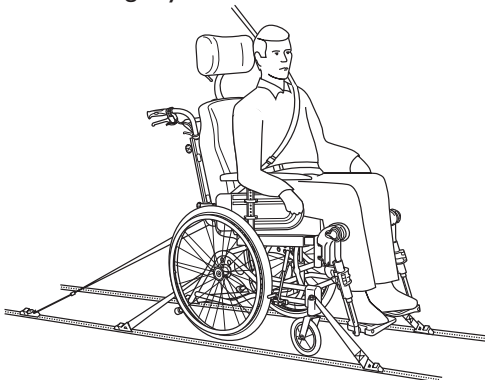

2. The wheelchair should be secured in the vehicle with a 4-point restraint system. The user should wear a 3-point safety belt secured in the vehicle. Both the 4-point restraint system and the 3-point safety belt should be approved according to ISO-10542-2.

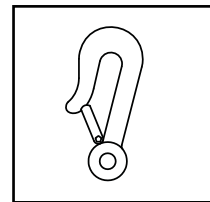

3. The tie-down points on the wheelchair where the restraint system straps should be placed are marked with this symbol.

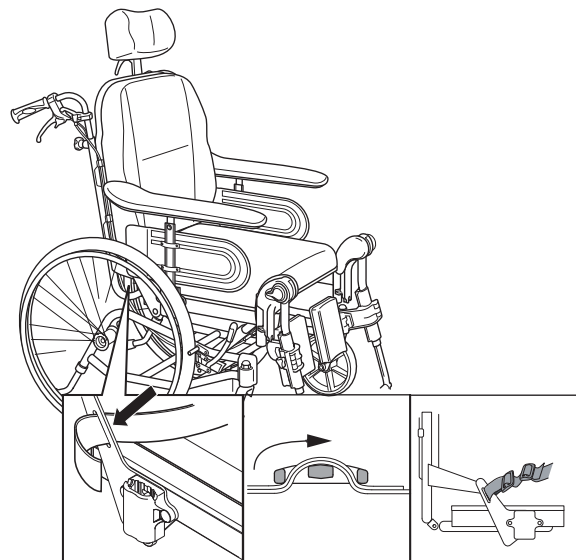

4. In order to be used as a seat during transport in a vehicle, the wheelchair must be equipped with a pelvic belt.

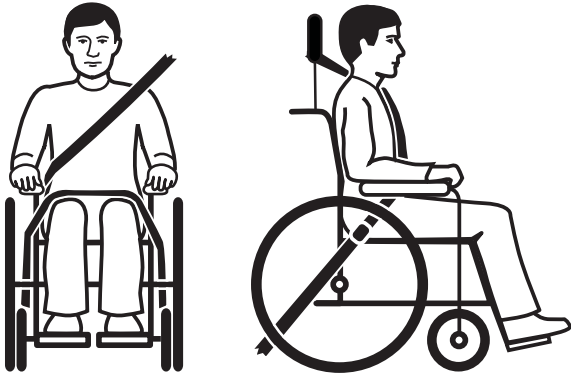

5. The vehicle's safety belt should fit as tightly across the user's body as possible without discomfort. The upper part of the safety belt should fit over the user's shoulder as illustrated. No part of the safety belt must be twisted.

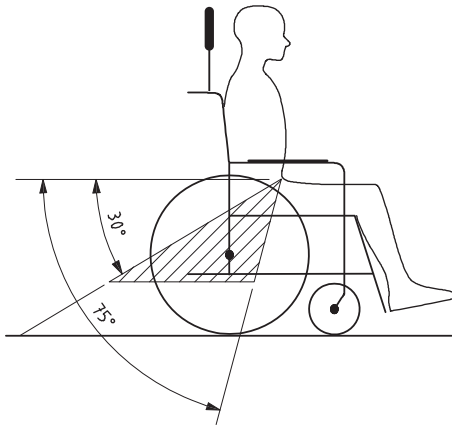

6. The pelvic part of the 3-point safety belt must be worn low across the pelvis so that the angle of the pelvic belt is within the preferred zone (A) of 30° to 75° to the horizontal. A steeper angle is preferred, but never exceeding 75°.



**Incorrect  
placement  
of safety  
belt**

7. The 3-point safety belt must not be held away from the user's body by parts of the wheelchair such as armrests or wheels etc.

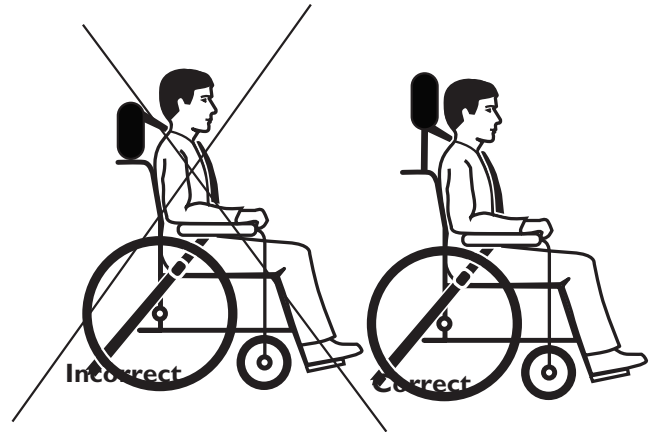

8. A headrest should always be used during transport and it should be adjusted as shown in the picture.

## CRASH TEST PROTOCOL REA CLEMATIS

## RESTRAINT METHODS

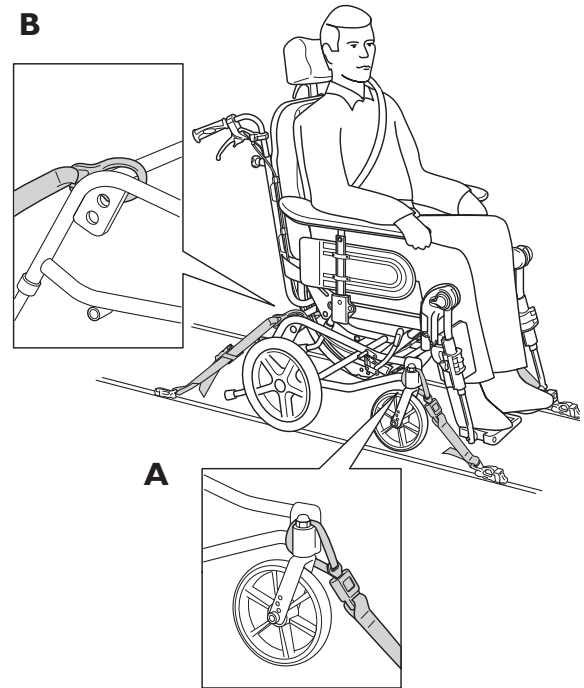
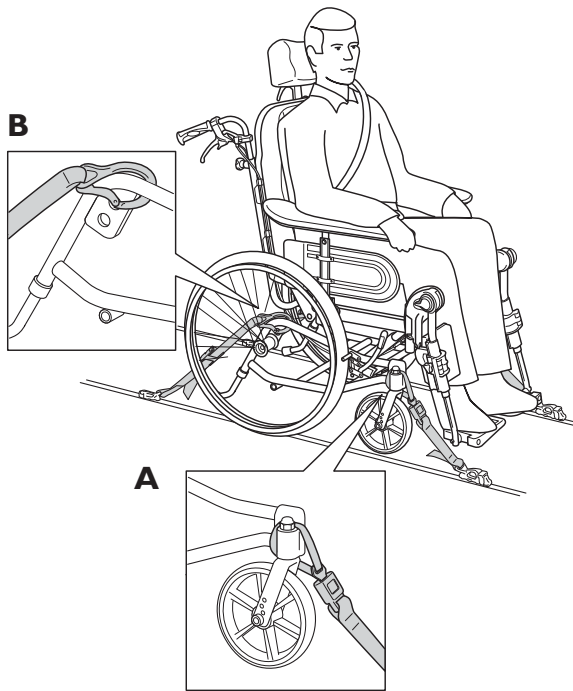

### A. Frontal restraints with straps

1. Connect the frontal straps around the castor attachment. See pic A.
2. Release brakes and tension front straps by pulling the wheelchair backwards. Re-apply wheelchair brakes.

### B. Rear restraints

1. Attach the snap hooks on the rear straps to the vertical rear tube by the rear wheel attachment.
2. Tighten the straps.

### C. Fastening of pelvic belt and safety belt

1. Check that the pelvic belt on the wheelchair is correctly fastened.
2. Fasten the 3-point safety belt around the user.



If there is no pelvic belt in on the wheelchair the user must transfer to the seat of the vehicle.



The safety belt should not be kept from the user's body by the parts of the wheelchair.



Never use the harness and pelvic belt in a vehicle as a safety belt. A belt designed for transport in vehicles must always be used.

## HOW TO DISSASSEMBLE YOUR CLEMATIS TO TRANSPORT IT AS LUGGAGE

1.

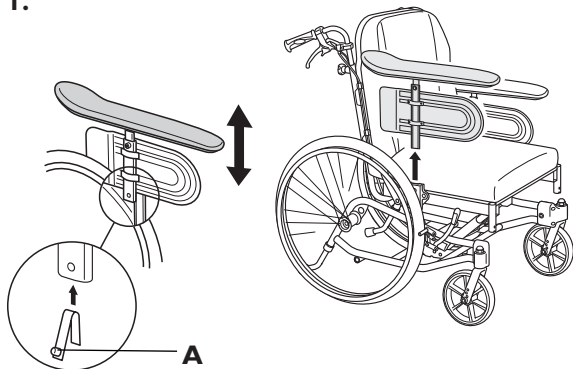

It is easy to prepare your Rea™ Clematis® for transport. Remove both the leg- and armrests. Fold the wheelchair and remove the wheels (if you have a chair with quick release wheels). You now have a chair that will easily fit into the luggage of a car.

### 1. Armrests

The armrest has an auto-lock. Press the spring button (A) before removing the armrest.

2.

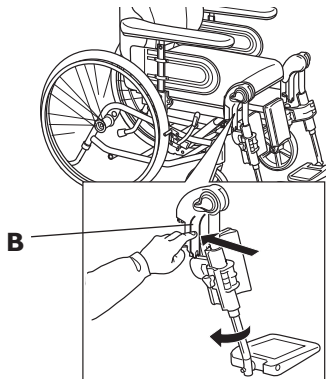

### 2. Legrests

The legrests are loosened by pushing the lever (B) forwards whilst turning the legrests outwards. You can then simply lift off the legrests.

3.

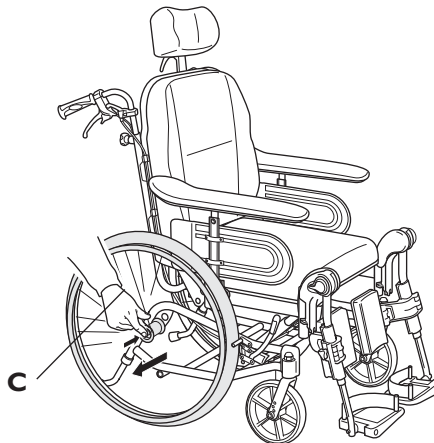

### 3. Rearwheels

Remove the rear wheels by pushing button (C) and pulling the wheel straight out.

4.

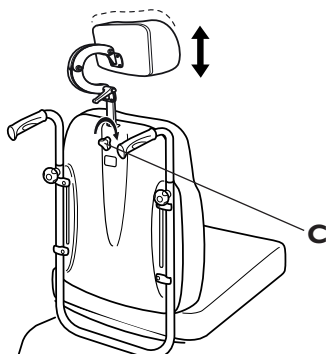

### 4. Neckrest

Remove the neckrest by loosening the knob (C) and lift it straight up.

5.

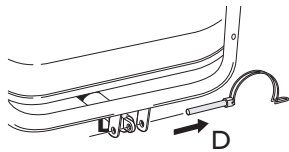
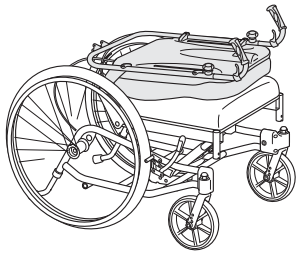

6.

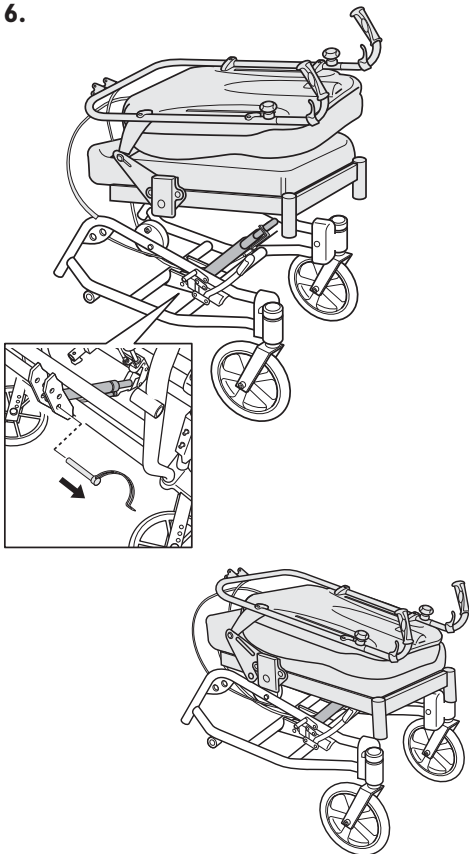

## 5. Backrest

Fold the backrest forwards by removing pin (D).

6. If you want to reduce the height of the chair even more, remove the pin (G) from the lower attachment of the lower gas piston.



Be careful not to trap your fingers between seat and frame.

# Safety instructions/propelling techniques

We recommend that you have the chair tested by the qualified person who has prescribed the wheelchair, after he or she has made the adjustments that you request, taking your build and needs into account. We hope that you have also received help in learning how best to use the wheelchair. Start by practising carefully until you are familiar with the wheelchair's possibilities and limitations.

## Moving to and from the wheelchair



Propel the wheelchair as near as possible to the seat that you want to move to. Apply the brake. Remove the armrests or move them upwards out of the way, and detach the legrests or swing them outwards. Do not support yourself on the footplates as this may cause the chair to tip forwards.

## Stretching and leaning



Propel the wheelchair as near as possible. When stretching and bending, do always have full contact between the backrest and the back otherwise the wheelchair may tip over. Stretching behind the backrest is not recommended.

## Propelling up a slope

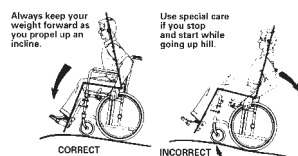

Many experienced users manage to propel up a slope by themselves. In order not to lose control of the steering and to avoid tipping backwards, you should always lean forwards whilst propelling up a slope. Propel the wheelchair forwards using short, quick strokes applied to the hand rims, in order to maintain speed and steering control.

Generally, help is needed in the case of steep slopes. If you have to stop on a slope, it is particularly important to ensure that you do not make any sudden or unexpected forward movements when you start moving the wheelchair forwards again. As the wheelchair is already leaning backwards, such a movement can cause the wheelchair to tip backwards.

## Propelling down a slope

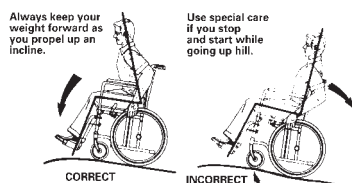

We recommend that you get the help of one or more Clematis® ants when going down steep and wet slopes.

First check the slope to see if there are any particular risks, such as potholes, slippery sections, etc. Never use your brake to slow down. When you apply the brake on a downward slope, the wheels lock and the wheelchair can suddenly pull to one side, tip sideways or stop immediately, which can cause you to be thrown out of the chair. Always control the speed with the hand rims. Remember that the hand rims may become hot due to friction, and this may cause injury to your hands. Try to propel down the slope in a straight line as much as possible. Never change direction when propelling down a slope. Never propel up or down a slope crosswise.

## Onto a kerb

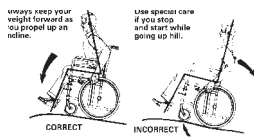

This method is for when the assistant is always behind the wheelchair and creates the greatest safety for the user.

The following advice is for the assistant:

Illustration 1) Adjust the anti-tip device upwards. Ensure that the user's feet rest securely on the footrests and cannot slide off. Then lean the wheelchair backwards and push it forwards against the kerb.

Illustration 2) Lower the frontal part of the wheelchair onto the pavement and place yourself as close to the chair as possible, before you lift up the whole wheelchair.

Illustration 3) Lean forward and lift/roll the wheelchair over the pavement edge.

Illustration 4) Lower the wheelchair onto the pavement so that the weight is divided on all four wheels. Ensure that the wheelchair does not roll backwards.

NB! If the wheelchair does not have a step tube or anti-tip device, tilt the backrest and seat backwards to make it easier to tip the chair backwards and thereby manoeuvre the castors over the obstacle/kerb more easily.

Follow the procedure above, but in reverse order (step 4, 3, 2 and then 1) to move off a kerb.

## Off a kerb

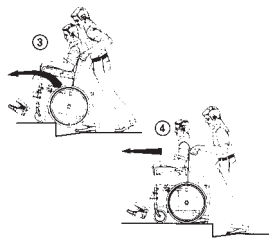

## Kerbs - alternative method

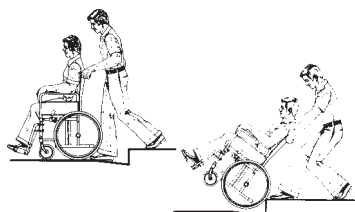

Generally this method is used by experienced assistants who are stronger than average. The method can also be used when the kerb or step is low and only constitutes a minimal obstacle.

The assistant goes backwards onto the pavement and then pulls the wheelchair up onto the pavement. It is important for the assistant to use his/her body correctly to prevent injury. Tip the wheelchair backwards and roll the chair over the kerb onto the pavement. Take particular care if the kerb is wet or slippery.

## Escalators

Do not use the escalator when in the wheelchair. Find out whether there is a lift nearby.

We advise you to avoid going up/down stairs in your wheelchair where possible, and to choose an alternative route instead.

## Stairs

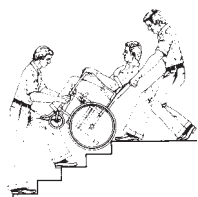

We recommend that you receive help from two assistants to get up and down stairs. One assistant goes in front of the chair and holds the frame of the wheelchair, whilst the other assistant goes behind the chair and holds the push handles. Fold the anti-tip device upwards. Balance the wheelchair on the drive wheels until the balance point is found. The wheelchair is then rolled down the stairs, step by step, by letting the drive wheels roll over the edge of each step. Assistants must remember not to hold removable armrests or legrests. In addition, assistants should remember to lift correctly, using their legs and keeping their backs as straight as possible.

# Guarantee

We provide a 2-year guarantee from the delivery date. The guarantee is valid from the day of delivery to the paying customer. Wear of parts is not included in the guarantee, for example upholstery, tyres, tubes, hand rims, castors etc. Damages, caused by physical violence, carelessness or abnormal usage are excluded. Damages, caused by heavier users than stated on the model plate, are excluded.

## Accidents/Near-accidents

Please inform your Invacare sales company (phone number is on the back cover) of any accidents/near-accidents that were caused by this wheelchair and that have led to/could have led to personal injury. The relevant authority in your country must also be notified.

## Testing

Rea™ Clematis® has been tested and approved by CERAH and is CE-marked according to the Medical Device Directive.

# Maintenance

It is easy to keep your Rea™ Clematis® wheelchair clean and in good condition.

## Cleaning

- Wipe metal sections and the upholstery regularly with a damp cloth. A mild detergent may be used. If necessary, the upholstery can be washed at 40°C. Ordinary washing powder/liquid can be used.

## Washing and Disinfection

1. Remove all loose and removable covers and wash these in a washing machine following the washing instructions for each article.
2. Spray the wheelchair with detergent, for example a car-cleaning agent with wax, and leave on to work.
3. Rinse the wheelchair with a high-pressure cleaning or ordinary jet of water depending on how dirty the chair is. Do not aim the jet towards bearings and draining holes. If the wheelchair is washed in a machine the water must not be hotter than 60 degrees.
4. Spray the chair with alcohol for disinfection.
5. Leave the chair to dry in a drying cabinet. Remove parts where water has collected for example in end tubes, ferrules etc. If the chair has been washed in a machine, blow-drying with compressed air is recommended.

## Wheels and tyres

- Wheel axles are to be wiped clean and lubricated with a drop of oil.
- Pneumatic tyres have valves similar to those on a car tyre, and the tyres can be pumped up using the same type of pump used for cars. The recommended air pressure for drive wheels is:

Standard tyres: 3.5 bar 50 psi

Low profile tyres 7.0 bar 90 psi

### **Technical servicing**

- Only original parts or those approved and fulfilling Invacare's specifications may be used.
- All technical servicing is to be carried out by an authorised wheelchair technician or by Invacare's service department. The wheelchair should be checked by authorised wheelchair technicians or Invacare's service department once a year. The address and telephone number are on the back cover of the manual.
- Check all parts of the wheelchair once a week. If you discover damage, please contact Invacare immediately. The address and telephone number are on the back cover of this manual.

### **Service life**

We estimate that Rea™ Clematis® has a service life span of five years. It is difficult to state the exact length of the service life of our products, and the length stated is an estimated average life span based on normal use. The life span may be considerably longer if the wheelchair is used to a limited extent, and if it is used with care, maintained and handled properly. The life span may be shorter if the wheelchair is subjected to extreme use.

## **Recycling**

The wheelchair Rea™ Clematis® can be divided into the following main components:

- Chassis
- Plastic parts
- Upholstery
- Wheels, tyres and tubes
- Packing

### **Chassis**

The chassis is produced in steel and is fully recyclable. Recycling of steel requires only 20-25% of the energy compared to new produced steel.

Clematis® has two gas pistons and they contain oil and must be disposed according to national requirements

### **Plastic parts**

The plastic parts in the chairs are produced of "Thermoplastic" and are marked with recycling symbols (where it is possible due to part size). The main plastic material is polyamide. This material can be recycled or burned in approved facilities.

### **Upholstery**

Upholstery is produced of polyester fibres, PUR or PVC. The efficient way to recycle the parts is to burn them in approved facilities.

### **Wheels, tyres and tubes**

- The hand rim, rim, spokes and hub are made of steel, stainless steel or aluminium and can be recycled according to above.
- Tyres and tubes are made of rubber and can be recycled according to above.

### **Packing**

All Invacare Rea AB packing material is developed to fit the products in an optimal way to reduce unnecessary material waste. All boxes are recyclable.

Contact your local recycling agent to obtain the correct information how to handle the above mentioned materials.

## **SURFACE TREATMENT**

Lacquered surfaces are lacquered with polyester. Some steel parts are zinc-plated. Not lacquered aluminium parts are anodised. Visible wooden parts are lacquered.





**Yes, you can.®**

**Manufacturer**

**Invacare Rea AB  
Växjövägen 303 S-343 71 DIÖ SWEDEN**

---

**Belgium & Luxemburg:**

**Invacare nv, Autobaan 22, B-8210 Loppem  
Tel: (32) (0)50 83 10 10, Fax: (32) (0)50 83 10 11  
belgium@invacare.com**

**Danmark:**

**Invacare A/S, Sdr. Ringvej 37, DK-2605 Brøndby  
Tel: (45) (0)36 90 00 00, Fax: (45) (0)36 90 00 01  
denmark@invacare.com**

**Deutschland:**

**Invacare Aquatec GmbH, Alemannenstraße 10,  
D-88316 Isny  
Tel: (49) (0)75 62 7 00 0, Fax: (49) (0)75 62 7 00 66  
info@invacare-aquatec.com**

**Ulrich Alber GmbH, Vor dem Weissen Stein 21,  
D-72461 Albstadt-Tailfingen  
Tel: (49) (0)7432 2006 0, Fax: (49) (0)7432 2006 299  
info@ulrich-alber.de**

**European Distributor Organisation:**

**Invacare, Kleiststraße 49, D-32457 Porta Westfalica  
Tel: (49) (0)57 31 754 540, Fax: (49) (0)57 31 754 541  
edo@invacare.com**

**España:**

**Invacare SA, c/Areny s/n, Polígon Industrial de Celrà,  
E-17460 Celrà (Girona)  
Tel: (34) (0)972 49 32 00, Fax: (34) (0)972 49 32 20  
contactsp@invacare.com**

**France:**

**Invacare Poirier SAS, Route de St Roch, F-37230  
Fondettes  
Tel: (33) (0)2 47 62 64 66, Fax: (33) (0)2 47 42 12 24  
contactfr@invacare.com**

**Ireland:**

**Invacare Ireland Ltd, Unit 5 Seatown Business  
Campus, Seatown Road, Swords, County Dublin -  
Ireland  
Tel: (353) 1 810 7084, Fax: (353) 1 810 7085  
ireland@invacare.com**

**Italia:**

**Invacare Mecc San s.r.l., Via dei Pini 62, I-36016  
Thiene (VI)  
Tel: (39) 0445 38 00 59, Fax: (39) 0445 38 00 34  
italia@invacare.com**

**Nederland:**

**Invacare BV, Celsiusstraat 46, NL-6716 BZ Ede  
Tel: (31) (0)318 695 757, Fax: (31) (0)318 695 758  
nederland@invacare.com  
csede@invacare.com**

**Norge:**

**Invacare AS, Grensesvingen 9, Postboks 6230, Etterstad,  
N-0603 Oslo  
Tel: (47) (0)22 57 95 00, Fax: (47) (0)22 57 95 01  
norway@invacare.com  
island@invacare.com**

**Österreich:**

**Invacare Austria GmbH, Herzog Odilostrasse 101, A-5310  
Mondsee  
Tel: (43) 6232 5535 0, Fax: (43) 6232 5535 4  
info@invacare-austria.com**

**Portugal:**

**Invacare Lda, Rua Estrada Velha, 949, P-4465-784 Leça do  
Balio  
Tel: (351) (0)225 1059 46/47, Fax: (351) (0)225 1057 39  
portugal@invacare.com**

**Sverige & Suomi:**

**Invacare AB, Fagerstagatan 9, S-163 91 Spånga  
Tel: (46) (0)8 761 70 90, Fax: (46) (0)8 761 81 08  
sweden@invacare.com  
finland@invacare.com**

**Switzerland:**

**Invacare AG, Benkenstrasse 260, CH-4108 Witterswil  
Tel: (41) (0)61 487 70 80, Fax: (41) (0)61 487 70 81  
switzerland@invacare.com**

**United Kingdom:**

**Invacare Limited, Pencoed Technology Park, Pencoed,  
Bridgend CF35 5HZ  
Switchboard Tel: (44) (0)1656 776200, Fax: (44) (0)1656  
776201  
Customer services Tel: (44) (0)1656 776222, Fax: (44)  
(0)1656 776220  
UK@invacare.com**